

DIAGNOSIS AND TESTING - HEATED SEAT ELEMENT

NOTE: For complete circuit diagrams, see Wiring Information.

NOTE: Front Seat shown. Back seat similar.

The wire harness connectors (1 and 2) for the heating elements are located under the seat.

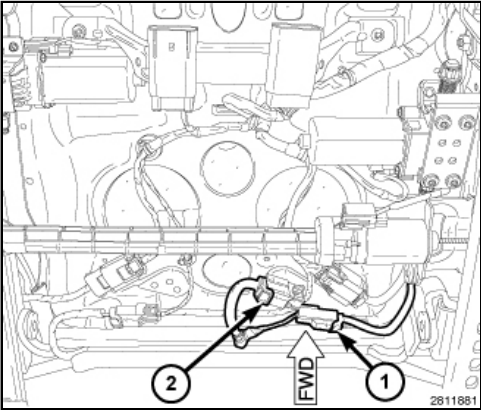

NOTE: When testing the heated seat elements for resistance, be certain to sit in the seat in question and move around the heating elements within the seat while testing. Moving the heating elements will help eliminate the possibility of an intermittent open in the element, which would only be evident in a certain position.

- 1. Locate and disconnect the seat electrical connectors as necessary.
- 2. Check the resistance between the circuits leading in and out of the suspect heated seat element. The resistance should be between the specifications listed in the following Heated Seat Element Resistance chart. If OK, [\(Refer to 08 - Electrical/8G - Heated/Cooled Systems/Heated Seats - Diagnosis and Testing\)](#). If not OK, replace the inoperative heated seat element [\(Refer to 08 - Electrical/8G - Heated/Cooled Systems/Heated Seats/PAD, Heater - Removal\)](#).

Seat Type and Position							Resistance (Ω)			Parallel resistance (Ω)			Temp (°C)	Tolerance (=/- %)
Platform	Model Year	Description	Front/Rear	Driver/Passenger/Both	Vented	Back/Cushion	Min	Nom	Max					
W3	15, 16, 17	HEATED SEAT BACK FRT	Front	Both	No	Back	5.49	6.86	8.23	2.65	3.32	3.98	20	20%
W3	15, 16, 17	HEATED SEAT CUSHION FRT	Front	Both	No	Cushion	5.14	6.42	7.70				20	20%
W3	15, 16, 17	HEATED SEAT BACK RR	Rear	Both	No	Back	8.39	10.49	12.59	4.61	5.76	6.91	20	20%
W3	15, 16, 17	HEATED SEAT CUSHION RR	Rear	Both	No	Cushion	10.21	12.76	15.31				20	20%
WD	11, 12, 13, 14, 15, 16, 17, 18	FOLD FLAT WD 85 TSTAT	Front	Passenger	No	Back	5.49	6.86	8.23	2.65	3.32	3.98	20	20%
WD	15, 16, 17, 18	HEATED SEAT CUSHION FRT	Front	Both	No	Cushion	5.14	6.42	7.70				20	20%
WD	11, 12, 13, 14, 15, 16, 17, 18	HEATED SEAT CUSHION RR	Rear	Both	No	Cushion	12.48	15.60	18.72	5.01	6.27	7.52	20	20%
WD	11, 12, 13, 14, 15, 16, 17, 18	HEATED SEAT BACK RR	Rear	Both	No	Back	8.38	10.48	12.58				20	20%

Seat Type and Position							Resistance (Ω)			Parallel resistance (Ω)			Temp (°C)	Tolerance (=/- %)
Platform	Model Year	Description	Front/Rear	Driver/Passenger/Both	Vented	Back/Cushion	Min	Nom	Max					
WD	13, 14, 15, 16, 17, 18	HEATING/VENTILATION SEAT BACK PLENUM FRT	Front	Both	Yes	Back	7.84	9.80	11.76	4.17	5.21	6.25	20	20%
WD	15, 16, 17, 18	HEATING/VENTILATION SEAT CUSHION PLENUM FRT	Front	Both	Yes	Cushion	8.90	11.13	13.36				20	20%
WD	11, 12, 13, 14, 15, 16, 17, 18	HEATED SEAT BACK FRT	Front	Both	No	Back	5.49	6.86	8.23	2.65	3.32	3.98	20	20%
WD	15, 16, 17, 18	HEATED SEAT CUSHION FRT	Front	Both	No	Cushion	5.14	6.42	7.70				20	20%
WD	15, 16, 17, 18	HEATED SEAT CUSHION FRT	0	0	No	Cushion	6.18	7.72	9.26	3.25	4.07	4.88	20	20%
WD	11, 12, 13, 14, 15, 16, 17, 18	HEATED SEAT BACK FRT	0	0	No	Back	6.88	8.60	10.32				20	20%
WK	11, 12, 13, 14, 15, 16, 17, 18	FOLD FLAT WD 85 TSTAT	Front	Passenger	No	Back	5.49	6.86	8.23	2.65	3.32	3.98	20	20%
WK	11, 12, 13, 14, 15, 16, 17, 18	HEATED SEAT CUSHION FRT	Front	Both	No	Cushion	5.14	6.42	7.70				20	20%
WK	13, 14, 15, 16, 17, 18	HEATING/VENTILATION SEAT BACK PLENUM FRT	Front	Both	Yes	Back	7.84	9.80	11.76	4.17	5.21	6.25	20	20%
WK	15, 16, 17, 18	HEATING/VENTILATION SEAT CUSHION PLENUM FRT	Front	Both	Yes	Cushion	8.90	11.13	13.36				20	20%
WK	11, 12, 13, 14, 15, 16, 17, 18	HEATED SEAT BACK FRT	Front	Both	No	Back	5.49	6.86	8.23	2.65	3.32	3.98	20	20%
WK	15, 16, 17, 18	HEATED SEAT CUSHION FRT	Front	Both	No	Cushion	5.14	6.42	7.70				20	20%
WK	11, 12, 13, 14, 15, 16, 17, 18	HEATED SEAT BACK RR	Rear	Both	No	Back	8.39	10.49	12.59	4.61	5.76	6.91	20	20%
WK	11, 12, 13, 14, 15, 16, 17, 18	HEATED SEAT CUSHION RR	Rear	Both	No	Cushion	10.21	12.76	15.31				20	20%